

# Hook

## 1-15—G43/G70

### G43/G70 Hook

Material: Carbon Steel(G43) / Alloy Steel(G70)

Breaking Strength: 4 times W.I.I.

Surface: Zinc Plating, Hot Dip Galvanized, Powder Painted

#### 1. Clevis Grab Hook

Part No.	Size Of Chain (in.)	Working Load Limit (lbs)		Weight (lbs)	Dimension (in)		
		H-330	A-330		B	E	P
TKR0028	1/4	2,600	3,600	0.4	0.36	0.4	0.38
TKR0029	5/16	3,900	5,400	0.79	0.4	0.44	0.44
TKR0030	3/8	5,400	7,500	1	0.48	0.5	0.47
TKR0031	7/16	7,200	10,000	1.5	0.66	0.56	0.56
TKR0032	1/2	8,200	12,750	2.1	0.75	0.66	0.63
TKR0033	5/8	12,750	19,000	4.2	0.91	0.78	0.75
TKR0034	3/4	18,500	27,000	6.5	0.94	0.94	0.88

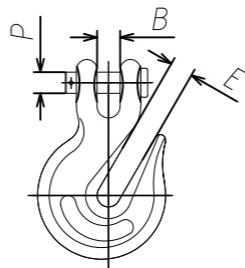

#### 2. Clevis Slip Hook with Latch

Part No.	Size Of Chain (in.)	Working Load Limit (lbs.)		Weight (lbs)	Dimension(in.)		
		H-331	A-331		B	E	P
TKR0035	1/4	1,950	2,750	0.5	0.44	0.79	0.38
TKR0036	5/16	2,875	4,300	0.75	0.5	0.93	0.44
TKR0037	3/8	4,000	5,250	1.2	0.59	1.14	0.47
TKR0038	7/16	5,000	7,000	2.06	0.66	1.18	0.56
TKR0039	1/2	6,500	9,000	2.8	0.75	1.42	0.63
TKR0040	5/8	9,250	13,500	5.18	0.91	1.65	0.75
TKR0041	3/4	12,500	19,250	10.45	1.31	1.81	1
TKR0042	1	17,600	26,500	13.65	1.38	1.98	1.14

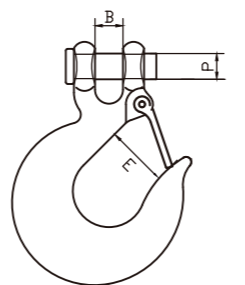

#### 3. 323 Eye Grab Hook

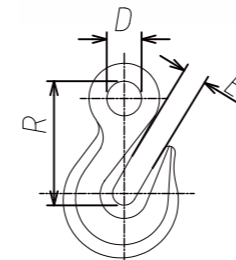
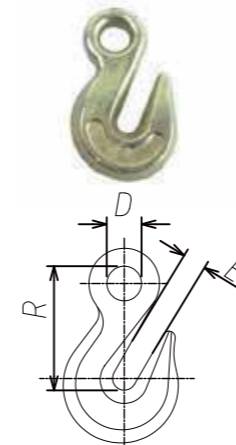

Part No.	Size Of Chain (in.)	Working Load Limit (lbs.)		Weight (lbs.)	Dimension (in)		
		H-323	A-323		D	E	R
TKR0043	1/4	2,600	3,600	0.28	0.5	0.34	1.97
TKR0044	5/16	3,900	5,400	0.45	0.56	0.44	2.25
TKR0045	3/8	5,400	7,500	0.79	0.66	0.5	2.56
TKR0046	7/16	7,200	10,000	1.19	0.75	0.56	2.94
TKR0047	1/2	9,200	12,750	1.8	0.88	0.66	3.38
TKR0048	5/8	12,750	19,000	3.3	1.06	0.78	4.11
TKR0049	3/4	18,500	27,000	6	1.38	0.94	5.16

#### 4. 320 Eye Hook with Latch

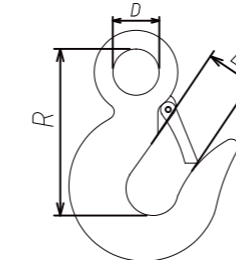

Part No.	Working Load Limit (t)		Weight (kg)	Dimension (mm)		
	320C	320A		D	R	E
TKR0050	1/2	3/4	0.18	16	71.1	20.5
TKR0051	3/4	1	0.25	19	81.7	21
TKR0052	1	1-1/2	0.41	23	93	23
TKR0053	1-1/2	2	0.59	28.4	103.8	24.5
TKR0054	2	3	0.93	31.8	118.9	26.5
TKR0055	3	4-1/2	1.77	39.6	146.6	33.5
TKR0056	5	7	3.25	50.8	188.5	38
TKR0057	7-1/2	11	5.9	61.9	230	48
TKR0058	10	15	10.15	73	257.7	57
TKR0059	15	22	16.25	89	316	74
TKR0060	20	30	27.2	90	255.9	98

#### 5. Swivel Hook With Latch

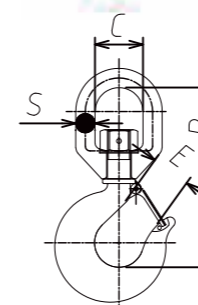

Part No.	Working Load Limit (t)		Weight (lbs)	Dimension (in.)			
	322C	322A		C	E	S	R
TKR0061	0.75	1	0.88	1.25	0.88	0.37	4.47
TKR0062	1	1.5	1.28	1.5	0.97	0.5	5.37
TKR0063	1.5	2	2.27	1.75	1	0.63	6.02
TKR0064	2	3	2.84	1.75	1.12	0.63	6.37
TKR0065	3	4.5	5.13	2	1.34	0.75	7.41
TKR0066	5	7	10.38	2.5	1.69	1	9.59
TKR0067	7.5	11	16.21	2.75	2.06	1.13	11.13
TKR0068	10	15	23.39	3.13	2.24	1.25	11.94
TKR0069	15	22	47.08	4.13	3.19	1.57	16.97
TKR0070	20	30	70.4	4.13	3.25	1.57	18.58

# Hook

## 7. Eey Slip Hook With Latch

Part No.	Size of Chain (in.)	Working Load Limit (lbs)		Weight (kg)	Dimension (in.)		
		H-324	A-324		D	E	H2
TKR0079	1/4	1950	2750	0.42	0.5	0.94	2.56
TKR0080	5/16	2875	4300	0.72	0.63	1.06	2.95
TKR0081	3/8	4000	5250	1.03	0.72	1.31	3.36
TKR0082	7/16	5000	7000	1.64	0.81	1.56	3.88
TKR0083	1/2	6500	9000	2.45	0.94	1.69	4.28
TKR0084	5/8	9250	13500	4.13	1.13	2.00	2.22
TKR0085	3/4	12500	19250	6.76	1.38	2.13	5.8

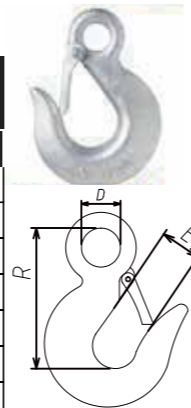

## 8. High Tensile Hook

Part NO.	Size of Chain (mm)	Working Load Limit (t)	Weight (kg)	Dimension (mm)		
				H1	H2	R
TKR0086	9-8	2.5	0.5	143	13.5	18.5
TKR0087	11-8	3.75	0.85	177	15.5	22
TKR0088	13-8	5.4	1.38	205	17.7	25.5

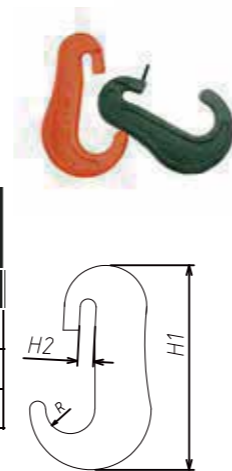

## 9. Eye Grab Bend Hook

Part NO.	Size of Chain (in.)	M.B.S.(t)	Weight (kg)	Dimension (mm)			
				D	E	H1	W
TKR0090	5/16	4.54	0.37	12.5	10.2	78	58.2
TKR0091	3/8	16	0.63	22	13	120	67.3

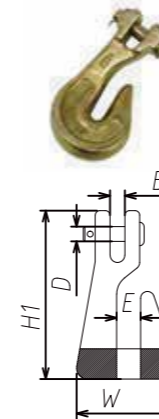
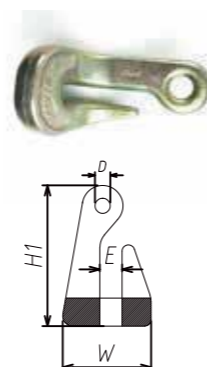

## 10. Clevis Grab Bend Hook

Part NO.	Size (in.)	M.B.S. (kg)	Weight (lbs.)	Dimension (in.)				
				B	E	H1	W	D
TKR0092	5.16	4.54	0.99	0.43	0.46	4.74	2.28	0.47

## 11. Clevis Grab Hook with Latch

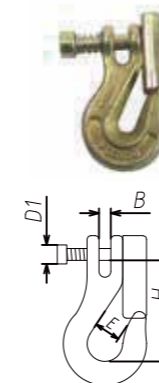

Part NO.	Size (in.)	Working Load Limit (t)		Weight (lbs.)	Dimension (in.)			
		Carbon Steel	Alloy Steel		B	E	H	D1
TKR0093	1/4	1.18	1.63	0.62	0.36	0.39	1.97	0.37
TKR0094	1/5	1.77	2.45	0.96	0.4	0.44	2.21	0.43
TKR0095	3/8	2.45	3.4	1.32	0.47	0.5	2.63	0.47
TKR0096	1/2	4.17	5.78	2.6	0.66	0.66	3.29	0.63
TKR0097	5/8	5.78	8.62	4.66	0.91	0.78	4.14	0.75

## 12. Trailer Hook



Part No.	Working Load Limit (t)	Weight (kg)	Dimension (mm)		
			D	E	H1
TKR0098	0.5	0.2	18	16.5	78.8
TKR0099	1	0.26	16	18	80.8
TKR0100	1.5	0.35	16	22	94
TKR0101	2	0.39	16	23	101.5

## 13. Chain with Delta Ring and Eye Grab Hook

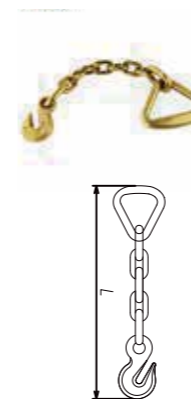

Part No.	Chain size (in.)	Delta Ring Size (in.)	Breaking Strength (t)	Weight (kg)	L (mm)
TKR0102	5/16	3	7.5	1.31	457
TKR0103	3/8	4	8.7	1.57	457

# Hook

## 14. Din689 European Eye Hook

Part No.	Working Load Limit (t)	Weight (kg)	Dimension (mm)				
			A	B	C	D	E
TKR0104	0.25	0.16	12	27	7.5	13	17
TKR0105	0.5	0.36	16	37	10	17.5	18
TKR0106	1	0.98	20	47	13.5	24	29
TKR0107	1.6	1.4	22	55	16.5	27	32
TKR0108	2.5	3.1	25	67	21	37.6	42

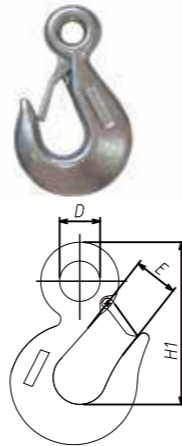

## 15. Triangle Hook with Safety Latch

Part No	Size (mm)	Breaking Strength (t)	Weight (kg)	Dimension (mm)			
				B	D	E	R
TKR0109	58	5	0.54	58	70	20	133
TKR0110	83	5	0.6	83	70	20	155

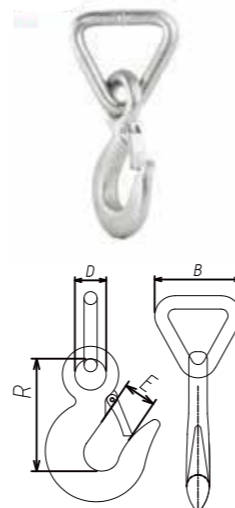

## 16. G80 Chain Sling Hook with Latch

Part NO.	Size (mm)	Working Load Limit (t)	Weight (kg)	Dimension (mm)			
				D	E	B	L
TKR0122	6	1.12	0.3	9	24	20	108
TKR0123	7-8	2	0.4	11	30	25	133
TKR0124	10	3.15	0.9	15	34	38	167
TLR0125	13	5.3	1.7	19	39	43	213
TKR0126	16	8	3.2	23	46	50	255
TKR0127	20	12.5	5.8	24	40	62	305
TKR0128	22	15	8.5	32	71	62	348
TKR0129	26	21.2	13	35	81	64	394
TKR0130	32	31.5	17	37	102	88	480

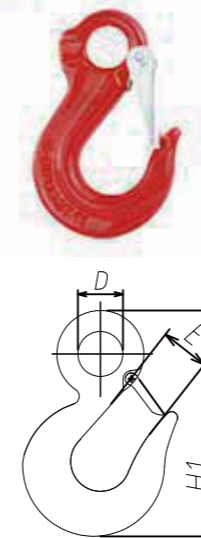

### 16-33—G80

G80 Hook

Forged Alloy Steel

Quenched & Tempered

Breaking Strength: 4 times W.L.L.

Surface: Powder Painted

# Hook

## 17. G80 Clevis Sling Hook with Latch

Part No.	Size (mm)	Working Load Limit (t)	Weight (kg)	Dimensions (mm)		
				H1	H2	E
TKR0131	6	1.12	0.32	76	8	26
TKR0132	7-8	2.0	0.48	85.5	9.5	29
TKR0133	10	3.15	0.95	104	13	39
TKR0134	13	5.3	1.8	128	16.5	47
TKR0135	16	8	3.4	150	21.5	55
TKR0136	20	12.5	6	180	24	61
TKR0137	22	15	10.4	213	27	72
TKR0138	26	21.2	14.5	250	30	85
TKR0139	32	31.5	27	317	35	106

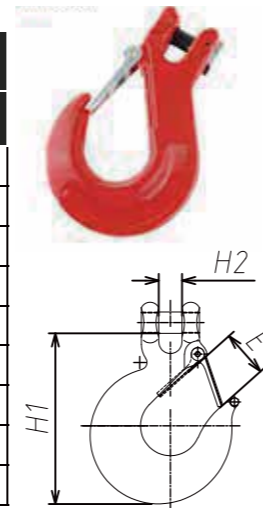

## 18. G80 Australia Eye Grab Hook with Wing

Part No.	Size (mm)	Working Load Limit (t)	Weight (kg)	Dimension (mm)			
				H	D	H1	E
TKR0140	6	1.12	0.17	18	13.5	76	8
TKR0141	7-8	2	0.25	18.5	17	87.5	10.8
TKR0142	10	3.15	0.65	29	20	120	13
TKR0143	13	5.3	1.39	42.8	26	156	16.5
TKR0144	16	8	2.2	43.5	30	167	19.2
TKR0145	20	12.5	4.6	56	37	219	24
TKR0146	22	15	8.2	68	44	259	28
TKR0147	26	21.2	9.8	77	51	298	30
TKR0148	32	31.5	19.4	95	57	360.5	38

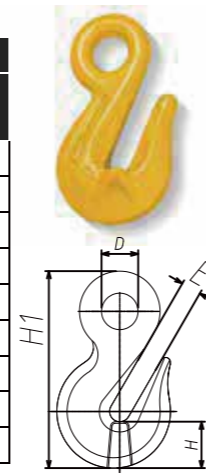

## 19. G80 Australia Clevis Grab Hook with Wing

Part No.	Size (mm)	Working Load Limit (t)	Weight (kg)	Dimension (mm)			
				B	E	H	L
TKR0149	6	1.12	0.21	8	8	18.5	76.5
TKR0150	7-8	2	0.32	9.5	10.8	18.8	88.5
TKR0151	10	3.15	0.78	12.5	13.5	29.5	124.5
TKR0152	13	5.3	1.65	15.5	16.5	42	160.5
TKR0153	16	8	2.86	19.5	20	44	182
TKR0154	20	12.5	5.05	24	24	54.8	214.5
TKR0155	22	15	6.32	27	27	68.5	254
TKR0156	26	21.2	14.5	30	30	77	309

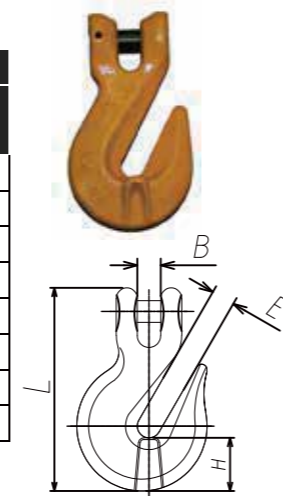

## 20. G80 Large Opening Eye Hook

Part No.	Working load limit (t)	Weight (kg)	Dimension (mm)		
			D	E	R
TKR0157	2	0.78	24	60	158
TKR0158	3.2	0.99	31	60	172.5
TKR0159	3.8	1.3	31	78	197.5
TKR0160	5.4	2.55	40	85.5	245
TKR0161	8	4.85	49	94	288
TKR0162	12.5	6.65	61	106	330

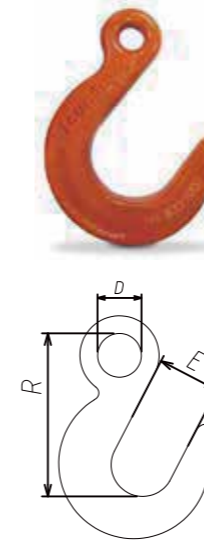

## 21. G80 Eye Safety Hook

Part No.	Size (mm)	Working Load Limit (t)	Weight (kg)	Dimension(mm)		
				D1	D2	L
TKR0163	6	1.12	0.5	22	33	110
TKR0164	7-8	2	0.86	24.8	42	132
TKR0165	10	3.15	1.52	32	55	167
TKR0166	13	5.3	3.15	40	67.2	204
TKR0167	16	8	6.1	56.5	83	250
TKR0168	20	12.5	8.1	62.6	96	269
TKR0169	22	15	12.6	70	96	312.5
TKR0170	26	21.2	21.9	80.5	106.8	362
TKR0171	32	31.5	44.4	105	166	470

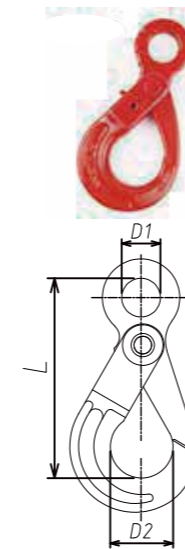

## 22. G80 Clevis Safety Hook

Part No.	Size (mm)	Working Load Limit (t)	Weight (kg)	Dimension(mm)				
				B	C	L	P	R
TKR0172	6	1.12	0.55	9.2	7.0	28.3	8.0	95.5
TKR0173	7/8	2	0.95	9.5	9.0	33.7	9.0	114.0
TKR0174	10	3.15	1.55	13	14.5	43.1	13.0	142.0
TKR0175	13	5.3	3.30	14.5	18.0	50.9	16.0	181.0
TKR0176	16	8	6.25	19.2	20.2	61.6	20.0	205.5
TKR0177	20	12.5	8.55	25.4	25.4	84.0	24.0	228.5
TKR0178	22	15	11.5	25.4	25.8	77.1	28.0	268.5
TKR0179	26	21.2	18.95	30	31.6	97.1	32.6	317.5
TKR0180	32	31.5	49.2	36	37.5	168	40	400.5

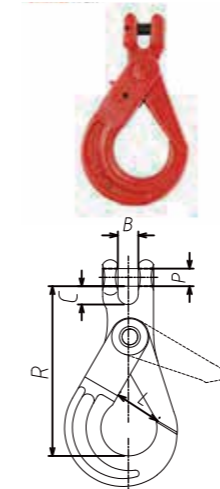

# Hook

23. G80 Swivel Safety Hook

Part No.	Size (mm)	Working Load Limit (t)	Weight (kg)	Dimension(mm)				
				B	C	D	R	r
TKR0181	6	1.12	0.75	32.5	24.5	11.5	149.5	16.5
TKR0182	7/8	2	1.25	35	25.4	13	182	21
TKR0183	10	3.15	2	42	32.2	15	215.5	27.5
TKR0184	13	5.3	4	49	43	17.5	265.5	33.6
TKR0185	16	8	7.8	61	55	21.5	323.3	41.5
TKR0186	20	12.5	10.2	71	59	26	356	48
TKR0187	22	15	16.6	96	89.5	33.7	449	48
TKR0188	26	21.2	23	122	115	42	544	53.4
TKR0189	32	31.5	81	140	146	52	679	83

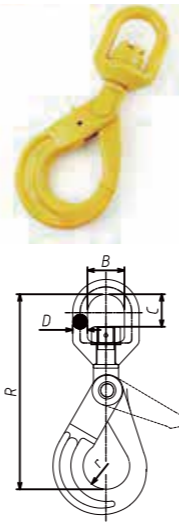

24. G80 Swivel Safety Hook

Part No.	Working Load Limit (t)	Weight (kg)	Dimension(mm)		
			D	E	L
TKR0190	2	0.78	24	60	158
TKR0191	3.2	0.99	31	60	172.5
TKR0192	3.8	1.3	31	78	197.5
TKR0193	5.4	2.55	40	85.5	245
TKR0194	8	4.85	49	94	288
TKR0195	12.5	6.65	61	106	330

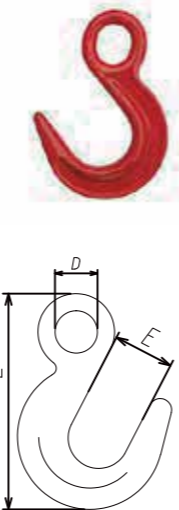

25. G80 Pipe Hook

Part No.	Working Load Limit (t)	Weight (kg)	Dimension(mm)		
			D	E	R
TKR0196	1	0.55	21.7	76.5	140.5

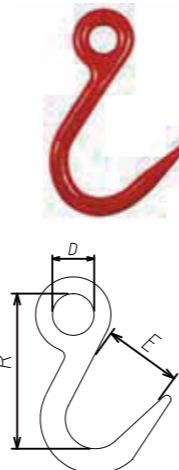

26. G80 Clevis Forest Hook

Part No.	Size (mm)	Working Load Limit (t)	Weight (kg)	Dimension(mm)		
				B	E	H1
TKR0197	7/8	2	0.41	9.5	10.5	95.5
TKR0198	10	3.15	0.92	13	13.5	135.5
TKR0199	13	5.3	1.75	16	16	165



27. G80 Weld on Hook

Part No.	Working Load Limit (t)	Weight (kg)	Dimensions(mm)			
			B	C	E	L
TKR0200	1	0.6	79.5	59	23	89.5
TKR0201	2	0.88	92	65	26.5	81
TKR0202	3	1.2	106	74.5	31	15
TKR0203	5	2.52	133	97	37.4	158.4
TKR0204	8	3.26	139.1	93.5	35.4	164
TKR0205	10	5.17	165.4	138.3	51	202.5

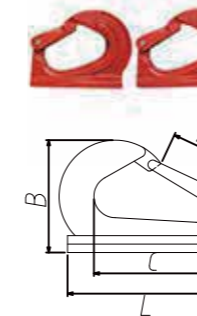

28. 398-H Hooks

Part No.	Size (in.)	MBS (lbs)	Weight (kg)	Dimensions(mm)			
				B	E	R	T
TKR0206	5/16	18800	0.39	17.5	25	75	23



# Hook

31. G80 Australia Clevis Grab Hook with Wing

Part NO.	Chain Size (in.)	Working Load Limit (t)	Weight (lbs.)	Dimension (In.)			
				L	L1	B	H
TKR0211	9/32	3,500	1.1	3.5	4.6	1.3	0.83
TKR0212	5/16	4,500		3.5	4.6	1.3	0.83
TKR0213	3/8	7,100	2.4	4.5	5.9	1.6	1.1
TKR0214	1/2	12,000	5.1	5.6	7.4	2	1.4
TKR0215	5/8	18,100	9	7.1	9.2	2.4	1.7
TKR0216	3/4	28,300	13.4	7.8	10.2	2.6	2

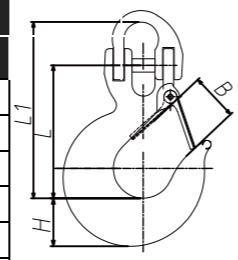

32. Shorting Hook

Part NO.	W.L.L. at Bottom (t)	W.L.L. at Tip of Hook (t)	Weight (kg)	Dimension(in)			
				E	F	G	H
TKR0217	7.5	2	2.91	9.69	7.37	1.38	2.81

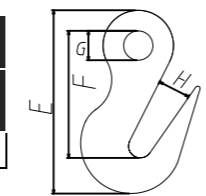

33. G80 Sliding Choke Hook

Part NO.	Working Load Limit (t)	Weight (lbs.)	Dimension (in)		
			H	E	H2
TKR0218	1.6	1.5	1.97	0.83	5.2
TKR0219	2	2.66	2.5	0.91	5.96
TKR0220	3	4.38	2.72	1.14	6.69
TKR0221	5	9.2	3.37	1.5	8.39

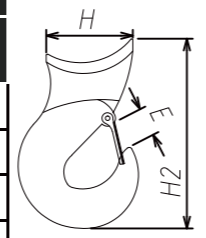

## 34-41— G70

G70 Hook

Material: Alloy Steel(G70)

Breaking Strength: 4 times W.L.I.

Surface: Zinc Plating, Hot Dip Galvanized, Powder Painted



34. R Hook

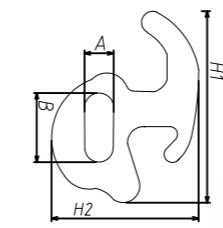

Part No.	Size (in.)	Breaking Strength (t)	Weight (kg)	Dimension (mm)			
				A	B	H1	H2
TKR0222	5/16	8.5	0.3	14.4	26	85.2	66.9



35. T Hook

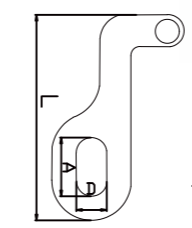

Part No.	Size (in.)	Breaking Strength (t)	Weight (kg)	Dimension (mm)		
				A	D	L
TKR0223	5/16	8.5	0.26	29	14.5	101



36. Small J Hook

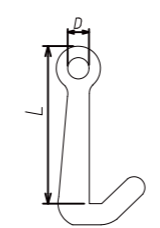

Part No.	Size (in.)	Breaking Strength (t)	Weight (kg)	Dimension (in)	
				D	L
TKR0224	5/16	8.5	0.32	0.57	4.14



37. J Sling Hook

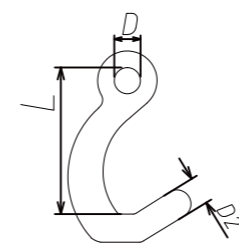

Part No.	Size (in)	Breaking Strength (t)	Weight (kg)	Dimension (in)		
				D	D2	L
TKR0225	5/16	8.5	0.32	0.57	0.63	3.59

# Hook

38. Clevis J Hook

Part No.	Size (in.)	Breaking Strength (t)	Weight (kg)	Dimension (mm)			
				A	B	C	D
TKR0226	8	8.5	1.24	210	12.4	12.7	25.5
TKR0227	15	8.5	1.5	366.8	12.4	12.7	23.7

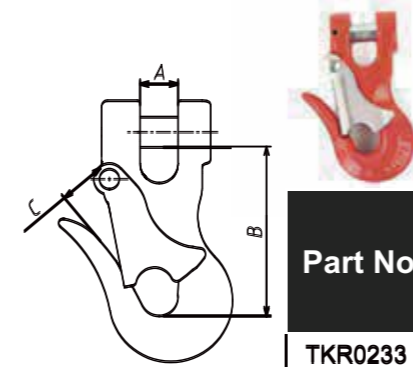
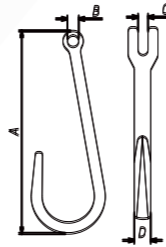

42. Custom Clevis Hook with Latch

Part No	Breaking Load (t)	Weight (kg)	Dimension (mm)		
			A	B	C
TKR0233	5	0.26	13.2	58.75	16.43

39. J Hook with Round Hole

Part No.	Size (in.)	Breaking Strength (t)	Weight (kg)	Dimension (mm)		
				B	E	L
TKR0228	8	8.5	1.15	19	105.5	171
TKR0229	15	8.5	1.75	19	105.5	348

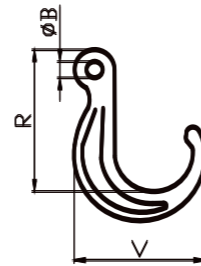

43. Weld on Grab Hook

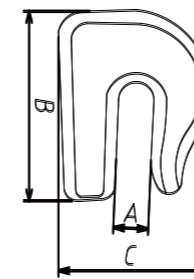

Part No	Size (in)	Weight (kg)	WLL (lbs)	Dimensions (mm)		
				A	B	C
TKR0234	5/16	0.21	4700	11.5	64	49.6
TKR0235	3/8	0.4	6600	13	76	60
TKR0236	1/2	0.79	11300	17.5	99.1	78.1
TKR0237	5/8	1.5	15800	20.6	127	103.9

40. J Type Hook with Ellipse Hole

Part No.	Size (in.)	Breaking Strength (t)	Weight (kg)	Dimensions (mm)			
				A	B	R	V
TKR0230	8	8.5	1.5	32	19.5	162	146
TKR0231	15	8.5	2	32	19.5	318.2	157.3

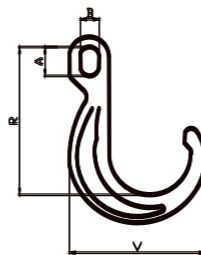

44. Weld on Grab Hook

41. Grab Hook with T Type Handle

Part No	Size (in.)	MBS (lbs.)	Weight (kg)	Dimension (mm)			
				E	H	I	R
TKR0232	5/16	18800	0.35	12	41	15.5	53

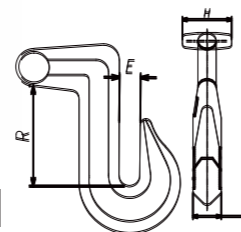

Part No	Size (in)	Weight (kg)	WLL (lbs)	MBS (lbs)
TKR0238	5/16"	0.755	3900	11700
TKR0239	3/8"	1.79	5400	19800